

Magnetic Cup and Mat System

The newly-designed system takes all of the guess work out of lining up the cup and mat with the hole in the upper platen of the water retention meter. The cup has a flat square surface with magnets in each corner. The mat has four magnets which line up with the ones on the cup for a tight seal.

Four simple steps to prepare for a test on the AA-GWR Water Retention Meter.

1. Place the filter and blotter paper on the mat (magnet side up).

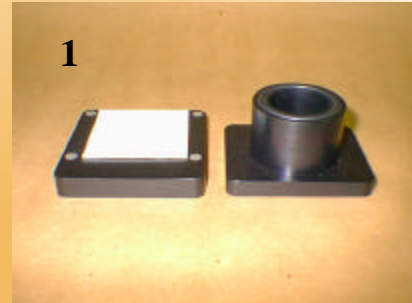

2. Set the cup section on the mat. The magnets will maintain the proper seal and alignment.



3. Add coating to the cup.

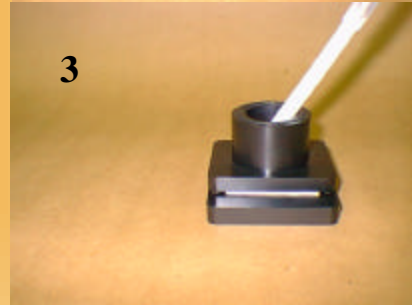

4. Install into the meter.



Water Retention Meter